

# ZAdisc Gearless elevator machine

SL506 / 510

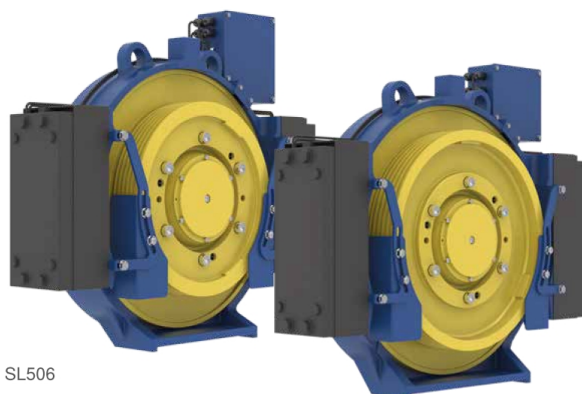

SL506

SL510

Synchronous motor actuated by permanent magnets and according to the provisions of the Lift Directive 2014/33/EU

## Drive

- NdFeB magnets
- Installation depth  $\leq 200$  mm
- Optimised for attaching to the guide rail
- Noise emissions:  $< 50$  dB(A)
- Insulation class F with temperature monitoring

## Brake system

- Safety component in accordance with Lift Directive 2014/33/EU
- Separately activated brake circuits
- Deployable as an element of the ascending car overspeed protection means
- Deployable as part of the protection against unintended car movement

Motor cables	Page 108
Deflection pulleys	Page 68
ZAlift	Page 73

## Technical data

SL506 / SL510

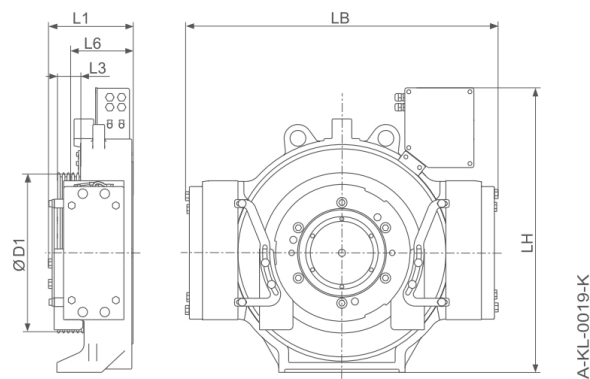

Motor type	Nominal torque Nm	Max. axle load kg	Nominal speed rpm	Rated output power kW	L1 mm	LH mm	L6 mm	LB mm	D1 mm	L3 mm	Weight kg
SL506.12-30	500	1800	96 - 156	5.0 - 8.2	217	721	158	793	400	66	310
SL510.17-28	870	2400	81 - 198	7.4 - 18.0	222	746	159	854	480	74	380

## Scope of delivery and options

SL506 / SL510	Standard	Options
Motor	Gearless elevator machine	-
Traction sheave	See D1	-
Brake	Certified brake system	-
Brake monitoring	Microswitch	Inductive proximity switches
Motor cable	-	10 m, 15 m, 20 m, 25 m halogen free
Absolute encoder	EnDat	SSI / SinCos / TTL
Rope guard	2 pieces	3. Rope guard
Temperature monitoring	PTC thermistor	PT100-thermistor
Cooling	Surface cooling	-
Mounting	-	Mounting bracket and bracket for rail mounting

## Resulting rope force

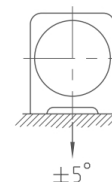

## Example configurations

Other configurations, also outside of the examples listed below, are possible.  
Our calculation software ZAlift is available to you for fast and convenient calculation of your elevator machine.

Suspension	Payload kg	Speed m/s	Traction sheave mm	Motor type	Number of ropes	Rope diameter mm	Motor power kW	Rated current A
2:1	480	1.00	400	SL506.12-30	3	10	5.0	19.4
	480	1.60	400	SL506.12-30	3		8.2	30.0
	630	1.00	400	SL506.12-30	3		5.0	19.4
	675	1.00	400	SL506.12-30	3		5.0	19.4
	675	1.60	400	SL506.12-30	3		8.2	30.0
	1050	1.00	480	SL510.17-28	4		7.4	28.0
	1050	1.60	480	SL510.17-28	4		11.8	42.0
	1050	2.00	480	SL510.17-28	4		14.5	50.0
	1050	2.50	480	SL510.17-28	4		18.0	61.0
	1125	1.00	480	SL510.17-28	4		7.4	28.0

Information

ZAtop

ZAtopx

ZAsyn

ZAdisc

ZAtop AM

System components  
motorsControl  
technologySystem components  
control  
technology

Appendix